

## Worldwide Service Team

### BRAZIL AGENT

TEL/FAX: +55-1137519942  
E-mail: george@naxo.com.br

### HUNGARY AGENT

TEL: +36-62534945  
FAX: +36-62534946  
E-mail: info@pmt-hu.eu

### INDONESIA AGENT

TEL: +62-21-897-0370  
FAX: +62-21-897-0371/72  
E-mail: sales@jayametal.com

### IRAN AGENT

TEL: +98-4132466250  
FAX: +98-4132466255  
E-mail: info@controlafzar.com

### KOREA AGENT

TEL: +82-226723387  
FAX: +82-226723384  
E-mail: nasee33@daum.com

### MEXICO AGENT

TEL / FAX: +52-4448253354  
E-mail: crosillo@prodigy.net.mx

### POLAND AGENT

TEL: +48-32-2148800  
FAX: +48-32-2148850  
E-mail: info@tfm.pl

### RUSSIA AGENT

TEL / FAX: +7(495)9955553  
E-mail: spolovnikov@perytone.ru

### TURKEY AGENT

TEL: +90-212-576-2537  
FAX: +90-212-549-4362  
E-mail: info@akesmakina.com

### UAE AGENT

TEL: +971-4-8816636  
FAX: +971-4-8814081  
E-mail: sales@rockwoodmachinery.com

### UKRAINE AGENT

TEL: +380-445835387  
FAX: +380-442846960  
E-mail: abotte@batex.ua



# BENDER

METAL TUBE & PIPE SOLUTION



旭東機械工業股份有限公司  
SHUZ TUNG MACHINERY INDUSTRIAL CO., LTD.

台中市外埔區大同里后寮路17-1號  
No. 17-1, Houliiao Rd., Waipu Dist, Taichung City, Taiwan.  
TEL: +886-4-2683-1886 / FAX: +886-4-2683-6158  
E-mail: stmc@shuztung.com.tw  
<http://www.shuztung.com>





## Company History

Established in 1978, Shuz Tung has been dedicated to manufacturing of various machinery and automation equipment. More than 30 years, Shuz Tung has accumulated advanced and professional techniques for superior production quality on practical and solid ground. The efforts and achievement are highly recognized by all the customers.

Outstanding capabilities of techniques and engineering, excellent working team, all of these firmly shape great competitiveness for Shuz Tung. Shuz Tung specialize in tube processing, manufacturing of tube bending machines, turn-key equipment for bicycles, tubes for furniture, etc. The product range consists of more than 2,000 models which are sold around the world.

Comprehensive and complete service is Shuz Tung's strength to guarantee 100% customers satisfaction. From fundamental production equipment, technical transferring, technical consultation to turn-key planning, customers are provided with highly effective, highly integrated supports for an overall view at production.

Advancing with the latest market trend to stay competitive and striving with all efforts to meet customers' needs-Shuz Tung is confidently pursuing the best quality to aim at the prosperous future in the new century!

## 公司簡介

自1978年成立以來，旭東公司致力於製造各式機械生產及自動化設備，歷經三十餘載，秉持實事求是的企業精神，累積了高度專業技術以及優越生產品質，獲得客戶一致的認同。

卓越的技術工程能力，加上優秀的工作團隊，紮實打造旭東的強勁競爭優勢。專於管類加工、彎管機生產、自行車整廠生產設備、管類家具等，生產達2000多種機型，銷售網遍佈全球。

周全而完善的整體服務，是旭東贏得客戶百分之百滿意度的另一驕傲。舉凡基本設備製造、完整技術轉移、技術顧問諮詢、整廠流程規劃等，提供客戶高效能高整合的整體生產版圖。

掌握市場脈動，與時俱進；切合客戶需求，全力以赴。旭東胸懷追求最佳品質的堅定信念，願與您一同邁向新世紀的蓬勃願景！





### 觸控式螢幕

- 17" 彩色觸控式螢幕，可選配多國語言。
- 採用 PC BASE，親和性程式 WIN PC 編輯及輸入。

### LCD TOUCH SCREEN

- 17" color touch screen with multiple languages for options.
- PC base with friendly WIN PC user programmable.



### 參數&3D模擬

- 參數可自由設定慢速退芯、輔推、穿心軸注油、自動回響以及反彈補償值。
- 120GB 硬碟供大量資料儲存。
- 3D 模擬預覽搭配零件測量，可減少試車材料損耗。

### PARAMETER LIST & 3D SIMULATION

- Able to set up mandrel pre-backward, booster, mandrel lubrication, auto bending reverse and spring back compensation.
- Data can be stored in 120GB HD.
- Measuring the product in 3D simulation to save the tube test run cost.

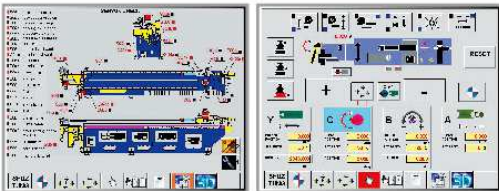

### 異常訊息

- 以文字及閃爍異常區塊提供操作可能異常狀況。

### ERROR MESSAGE

- Error description and flashing alarm on abnormal operational section, able to offer instant trouble shooting.



### CMM 檢測輸入：

- 以檢測手臂量測零件，輸出報告含 Y, B, C 以及 X, Y, Z，即可輸入彎管機成為彎管程式。

### TRANSFER FROM CMM REPORT

- Measure sample by CMM ARM, report contents "Y, B, C" & "X, Y, Z", insert the report data to bender.

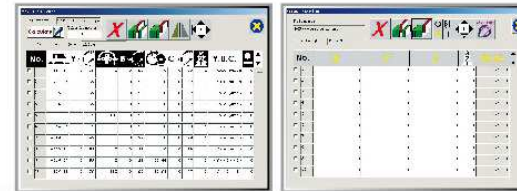

## 彎管機類型 BENDER SERIES

### CNC BR1/2

單層模/雙層模，可搭配彎管或捲圓。  
Single/Dual stacks for bending or rolling.

### CNC B1/2

單層模/雙層模，可做彎管。  
Single/Dual stacks for bending.

### NCB

數值控制。  
Numeric control type.

### CNC BR3/M

多層模，除彎管/捲圓外，另可搭配沖孔或沖切。  
Multi stacks for bending and rolling.  
Option function for hole punching and punching cut.

### AUTO

單層模，可做彎管。  
Single stack for bending.

## 彎管模具 BENDING DIES

機型 MODEL	彎曲模 BENDING DIE	彎曲夾模 CLAMPING DIE	彎曲導模 PRESSURE DIE	單/多珠芯桿 SINGLE/MULTI-BALL MANDREL	傾轉夾模 CLAMP CHUCK	背板 WIPER DIE
CNC BENDING 彎曲模	A1, A2, A3	B1, B2, B3	C2	D1, D2, D3	E1	F1
CNC ROLLING 捲圓模	A4	C3	B4	D1, D2, D3	E1	-
AUTO BENDING 彎曲模	A2, A3	B1, B2, B3	C1, C2	D1, D2, D3	E1	F1
NC BENDING 彎曲模	A2, A3	B1, B2, B3	C1, C2	D1, D2, D3	-	F1

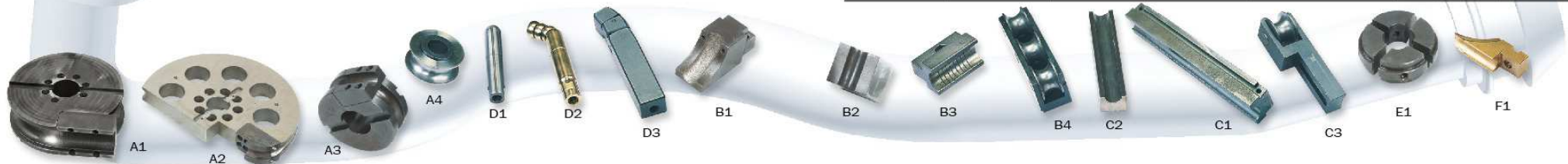

CNC16



CNC25



CNC38



CNC50



CNC65/CNC80



CNC100



CNC130/CNC150



CNC170



## ACCESSORIES OPTION



### 捲圓機構

- 適用彎曲半徑大於6D以上運用伺服送料機構推送管件達捲圓及3D弧形需求

### PUSH BEND DEVICE

- Suitable for the bending radius bigger than 6D
- Servo feeding device push pipe forming the bigger radius and 3D curvature shape.



### 沖孔機構

- 第二機層可因應需求更換彎管或沖孔機構
- 在彎曲加工同時執行沖孔功能，可避免二次加工的時間

### HOLE PUNCHING DEVICE

- Able to exchange 2nd stack via bending device or hole punching device.
- To make hole punching & bending process at one operation, avoiding 2nd processing job on hole process.

## CE VERSION



### CE規格

- 加裝安全護蓋，懸吊式開關，風扇冷卻

### CE SPECIFICATION

- With safety cover, hanging switch and fan coolant.

CNC20BR8



CNC32BR8



# NC SERIES

NCB25



NCB38



NCB50



NCB65/NCB80



NCB100



NCB130



NCB150/NCB170



AUTO38/AUTO63



CNC38B1/CNC50B1



CNC 控制系列 CNC CONTROL SERIES																	AUTO		NC 控制系列 NC CONTROL SERIES										
機型/MODEL	伺服彎曲 Bending Servo Control								油壓彎曲 Bending Hydraulic Control									AUTO		NC 控制系列 NC CONTROL SERIES									
	CNC 10 B1 CNC 16 B2 CNC 16 B3	CNC 25 BR1 CNC 25 BR2 CNC 25 BR3	CNC 38 BR1 CNC 38 BR2 CNC 38 BR3	CNC 50 BR1 CNC 50 BR2 CNC 50 BR3	CNC 65 BR1 CNC 65 BR2 CNC 65 BR3	CNC 80 BR1 CNC 80 BR2 CNC 80 BR3	CNC 100 BR1 CNC 100 BR2	CNC 20 BR8	CNC 32 BR8	CNC 38 B1	CNC 50 B1	CNC 65 B1	CNC 80 B1	CNC 100 B1 CNC 100 B2	CNC 130 B1 CNC 130 B2	CNC 150 B1 CNC 150 B2	CNC 170 B1 CNC 170 B2	AUTO 38	AUTO 63	NCB 25	NCB 38	NCB 50	NCB 65	NCB 80	NCB 100	NCB 130	NCB 150	NCB 170	
動力 Horse Power	11HP	12.5HP	18HP	30HP	42HP	54HP	63HP	13HP	27HP	14HP	20HP	26HP	32HP	45HP	48HP	48HP	53HP	6HP	11.7HP	7.5HP	7.5HP	10HP	15HP	20HP	25HP	37.5HP	37.5HP	40HP	
適用最大外徑 Max. Bending Capacity (mm)	16x1.2	25x1.5	38x2	50x2	65x2.2	80x3	100x3	20x1.2	32x1.8	38x2	50x2	65x3	80x4	100x6	130x7	150x8	170x7	38x2	63x2	25x1.2	38x2	50x2	65x2.2	80x4	100x6	130x7	150x8	170x7	
彎曲最大半徑 Max. Bending Radius (mm)	80	100	200	220	220	250	350	90	150	200	220	220	250	350	450	500	600	180	250	120	300	450	450	500	500	500	600	600	
彎曲最大角度 Max. Bending Angle (°)	190	190	190	190	190	190	190	190	190	190	190	190	190	190	190	190	190	190	190	190	190	190	190	190	190	190	190	190	
最大穿心軸定位距離 Max. Feeding Positioning Length (mm)	1300	1800	2500	2500	2500	3000	3000	1500	2500	2500	2500	2500	3000	3000	3000	4000	4000	2000	2500	--	--	--	--	--	--	--	--	--	
穿心軸長度 Max. Feeding Length With Mandrel (mm)	2250	2800	3600	3700	3500	4400	4600	2600	3800	3700	3700	3900	4400	4600	5000	6000	6700	2900	3800	950	2000	2000	2300	2300	3000	3000	4000	4200	
彎曲精度 Bending Accuracy (°)	±0.05	±0.05	±0.05	±0.05	±0.05	±0.05	±0.05	±0.05	±0.05	±0.1	±0.1	±0.1	±0.1	±0.1	±0.1	±0.1	±0.1	±0.2	±0.2	±0.1	±0.1	±0.1	±0.1	±0.1	±0.1	±0.1	±0.1	±0.1	
彎曲速度 Bending Speed (°/sec)	214	200	150	120	80	70	35	257	240	110	50	35	21	15	10	5	5	40	30	210	60	35	30	15	10	10	5	5	
送料精度 Feeding Accuracy (mm)	排齒 Rack	±0.1	±0.1	±0.1	±0.1	±0.1	±0.1	±0.1	--	±0.1	±0.1	±0.1	±0.1	±0.1	±0.1	±0.1	±0.1	±0.2	±0.2	--	--	--	--	--	--	--	--	--	
	螺桿 Ball screw	±0.01	±0.01	±0.01	±0.01	--	--	--	±0.01	--	--	--	--	--	--	--	--	--	--	--	--	--	--	--	--	--	--	--	--
送料速度 Feeding Speed (mm/sec)	1~1200	1~1100	1~1000	1~1000	1~800	1~800	1~600	1~1250	1~1100	1~1000	1~1000	1~800	1~800	1~600	1~600	1~600	1~600	1~500	1~500	--	--	--	--	--	--	--	--	--	
傾轉角度 Turning Accuracy (°)	±0.1	±0.1	±0.1	±0.1	±0.1	±0.1	±0.1	±0.1	±0.1	±0.1	±0.1	±0.1	±0.1	±0.1	±0.1	±0.1	±0.1	±0.2	±0.2	--	--	--	--	--	--	--	--	--	
程式組數 Number Of Programs	No Limited								200									50		99									
每組可彎組數 Bending No. / Program	No Limited								30 Edit Lines / Program									15 Edit Lines / Program		20 Edit Lines / Program									
轉角速度 Turning Speed (°/sec)	360	240	240	200	150	150	100	308	240	240	200	150	150	100	100	82	82	120	120	--	--	--	--	--	--	--	--	--	
多層模半徑差 Radius Difference Between Stacks (mm)	25	40	45	80	80	90	100	No Limited	No Limited	45	80	80	90	100	150	170	190	--	--	--	--	--	--	--	--	--	--	--	
機械外型 Dimensions (cm)	300x76x140	375x88x140	445x118x140	500x145x155	540x120x150	600x142x180	740x200x180	390x200x145	450x180x195	495x105x130	500x145x155	525x135x135	580x140x150	690x210x175	705x226x179	900x250x180	1052x280x200	390x110x130	520x128x135	190x92x130	300x87x130	315x105x140	360x130x130	375x165x130	492x170x175	520x220x175	745x234x190	752x285x200	
重量 Weight (kg)	1300	1600	2400	3500	4000	6000	6500	4500	6000	2300	3200	4400	5000	7600 8500	12000 13000	18500 20000	24000 26000	2000	3000	540	1140	1300	1900	3800	6500	11000	13000	17000	

### 備註 KEY

- A 請參閱右圖所示
- B Please refer to the drawing in the right side.

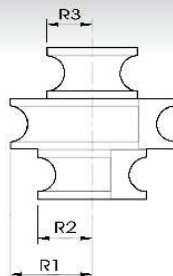

多層模可加選沖孔及沖切功能。  
4th axis CNC is available as option during multi-stack operation to provide hole punching and punching cut.

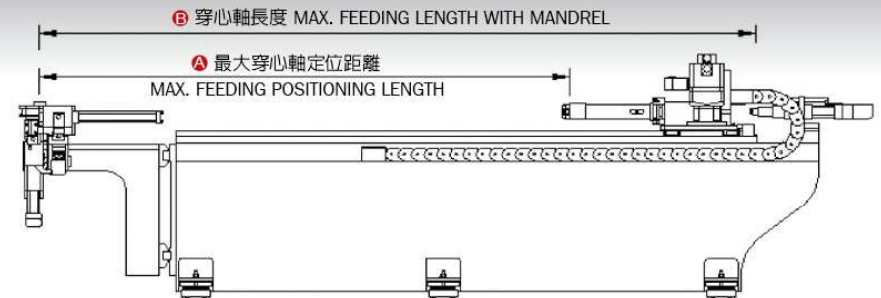

The manufacturer always performs product improvements to achieve the best possible performance. All specifications, dimensions and design characteristics shown in this catalogue are subject to change without notice. (Product specifications are based on the actual machines.)  
本公司隨時在進行研究改進的工作，因此保有隨時更改設計、規格尺寸及機械機構之權利，產品規格依實物為準，若有任何變更，恕不另行通知。

**NCB38H**



**NCB50H**

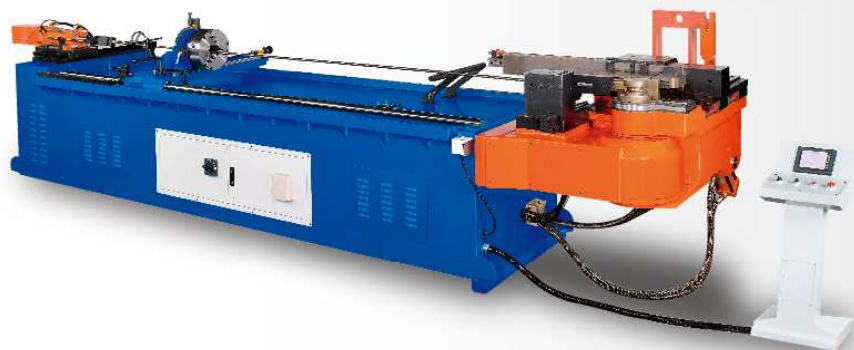

角度傾轉 / ANGLE ROTATING



長度定位 / LENGTH SETTING

**DB38**

雙彎管機  
DOUBLE HEADS BENDER



機型/MODEL	DB38 1000	DB38 1500	DB38 2000	DB38 2500
適用最長兩彎距離 Max. distance between 2 shafts (mm)	1000	1500	2000	2500
適用最大外徑 Max. bending capacity	38			
適用彎曲半徑 Available bending radius (mm)	30~150			
彎曲最大角度 Max. bending angle (°)	190			
動力 Horse power (HP)	7 1/2-4P			

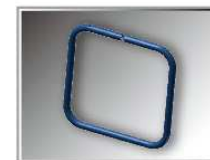

**DDB38**

二次雙彎管機  
DOUBLE HEADS BENDER (Two Times Finish)

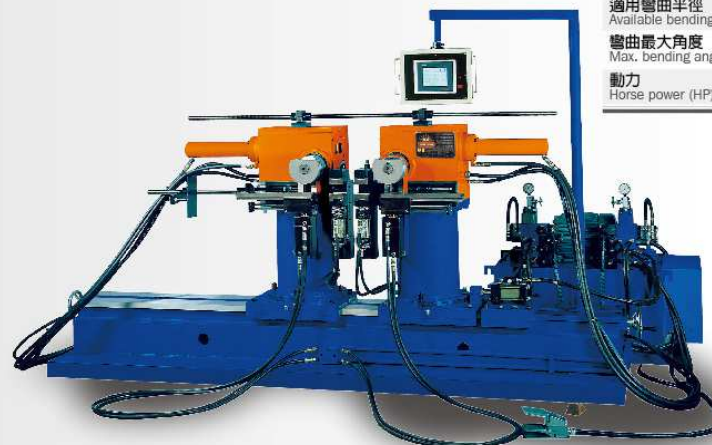

機型/MODEL	DDB38 1500	DDB38 2000	DDB38 2500
適用最長兩彎距離 Max. distance between 2 shafts (mm)	1500	2000	2500
適用最大外徑 Max. bending capacity	38		
適用彎曲半徑 Available bending radius (mm)	30~150		
彎曲最大角度 Max. bending angle (°)	190		
動力 Horse power (HP)	7 1/2-4P		

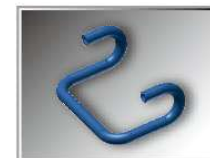

**VRB**

立式捲圓機  
VERTICAL ROLLING BENDER

機型/MODEL	VRB 38	VRB 50
適用最大外徑 Max. rolling capacity (mm)	38.1	50
最大捲圓半徑 Max. rolling radius (mm)	5D~600	5D~650
捲圓速度 Rolling speed (mm/sec)	200	200
動力 Horse power (HP)	5	7.5
機械外型 Dimensions (cm)	230x100x200	230x140x220
重量 Weight (kg)	1100	1500



**HRB**

臥式捲圓機  
HORIZONTAL ROLLING BENDER

機型/MODEL	HRB 38	HRB 50
適用最大外徑 Max. rolling capacity (mm)	38.1	50
最小捲圓半徑 Min. rolling radius (mm)	100	200
捲圓速度 Rolling speed (mm/sec)	200	200
動力 Horse power (HP)	3	7
機械外型 Dimensions (cm)	120x90x130	130x90x110
重量 Weight (kg)	1100	2000



**SB-05**

機型/MODEL	SB-05
適用最大外徑 Max. bending capacity (mm)	15.8x0.7
彎曲最大半徑 Max. bending radius (mm)	10~19
彎曲最大角度 Max. bending angle (°)	182°
彎曲精度 Bending accuracy (°)	±0.5°
穿心軸長度 Length of mandrel (mm)	175
彎曲速度 Bending speed (°/sec)	150
動力 Horse power (HP)	9
機械外型 Dimensions (cm)	773x122x170
重量 Weight (kg)	3040



**HT-90-94**

花管機  
ROTARY SWAGING MACHINE



機型/MODEL	380F	500F	500FA	800F	800FA	1000FA	1500F
適用外徑 Capacity (mm)	12~38	15~50	15~50	15~80	15~80	50~100	50~100
機械時間 M/C cycle time (sec/pc)	8~15	8~25	25~60	25~60	35~80	40~100	40~100
一次完成管長 Rolling speed (mm/sec)	300	300	700	300	500	300	350
動力 Horse power (HP)	12 1/4	17 1/4	23 1/4	30 1/4	35 1/4	35 1/4	35 1/4
機械外型 Dimensions (cm)	175x160x160	185x170x160	200x170x160	190x185x170	210x185x170	220x200x175	200x220x180
重量 Weight (kg)	3200	4200	5200	6000	6800	8000	8800

**HT-90-95**

藤管機  
MALACCA MACHINE



機型/MODEL	500MF	1000MF
適用外徑 Capacity (mm)	9.5~50	50~101
適用管厚 Tube thickness (mm)	0.5~1.5	0.5~1.8
機械時間 M/C cycle time (sec/pc)	10	40
動力 Horse power (HP)	7	10
機械外型 Dimensions (cm)	70x100x110	120x120x130
重量 Weight (kg)	700	1500





### HT-10-229

管端成型機-單站式  
PIPE END FORMING M/C - SINGLE STATION

機型/MODEL	HT-10-229(38)	HT-10-22F(50)	HT-10-22U(65)
適用最大外徑 Max. capacity (mm)	38x1.5	50x2.0	65x2.0
適用管件長度 Length of tube (mm)	300~2200	300~2200	300~2200
成型行程 Forming stroke (mm)	150	150	150
機械時間 M/C cycle time (sec/pc)	9~15	9~15	9~15
動力 Horse power (HP)	7.5	15	15
機械外型 Dimensions (cm)	255x100x170	220x110x170	265x160x195
重量 Weight (kg)	1000	1200	2500

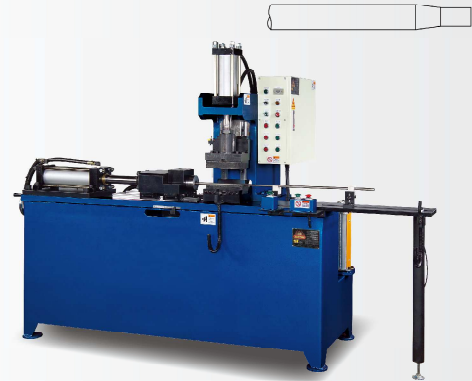

### HT-10-22D/G

管端成型機-多站式  
PIPE END FORMING  
M/C - MULTIPLE STATIONS

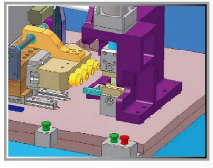

機型/MODEL	HT-10-22D(38)	HT-10-22G(50)
適用最大外徑 Max. capacity (mm)	38x1.5	50x2.0
機械時間 M/C cycle time (sec/pc)	6~20	15~20
動力 Horse power (HP)	7.5	15
控制系統 Control	Servo Moving	Cylinder Moving
換模時間 Change time (min)	6	6
機械外型 Dimensions (cm)	150x120x170	210x150x175
重量 Weight (kg)	1500	2300



### HT-10-78

旋溝機  
PIPE END GROOVING MACHINE



機型/MODEL	HT-10-780	HT-10-782
適用最大外徑 Max. capacity (mm)	10x0.5	30x1.0
動力 Horse power (HP)	2	3
機械時間 M/C cycle time (sec/pc)	6~8	12~14
機械外型 Dimensions (cm)	110x75x125	140x110x150
重量 Weight (kg)	500	840

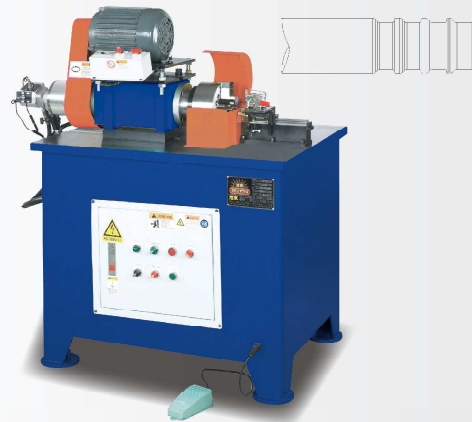

### HT-490-690

雙頭管端成型機  
DUAL END FORMING MACHINE

機型/MODEL	HT-490-690
適用外徑 Capacity (mm)	50.8~76.2
成型行程 Forming stroke (mm)	30~75
機械時間 M/C cycle time (sec/pc)	6~10
動力 Horse power (HP)	15
機械外型 Dimensions (cm)	175x100x200
重量 Weight (kg)	1400

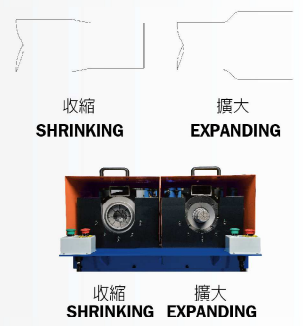

### HT-90-06

單頭鐵管內外角倒角機  
PIPE END CHAMFERING M/C

機型/MODEL	50 TYPE	80 TYPE	155 TYPE	305 TYPE
適用外徑 Capacity (mm)	12.7~50.8	6~80	40~155	105~305
適用最大管厚 Max. wall thickness (mm)	3.5	2	8	20
適用實心館 Capacity, solid bar (mm)	6~12.7	--	16~155	--
動力 Horse power (HP)	2	2	3	4
機械外型 Dimensions (cm)	70x70x105	104x78x151	110x82x130	145x230x168
重量 Weight (kg)	120	450	550	1950

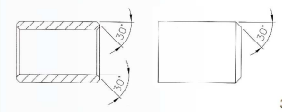
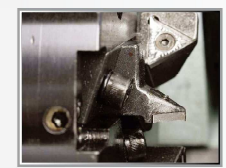

雙頭倒角機 (規格另洽)  
OPTION: DOUBLE ENDS  
CHAMFERING M/C

### HT-90-206

管端沖圓弧機  
PIPE END NOTCHING M/C

機型/MODEL	HT-90-20C	HT-90-206	HT-90-208
適用最大外徑 Max. capacity (mm)	38	50	80
適用最大管厚 Max. wall thickness (mm)	1.6	2	3.5
適用管件長度 Length of tube (mm)	180~1000	180~1000	180~1200
可調整角度 Adjustable angle (°)	0~180	0~180	65~180
機械時間 M/C cycle time (sec/pc)	6	6	8
動力 Horse power (HP)	7.5	7.5	15
機械外型 Dimensions (cm)	150x180x170	155x200x170	265x200x200
重量 Weight (kg)	1000	1200	2800

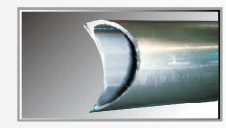

**HT-20-01**

斜度成型機  
SWAGING M/C

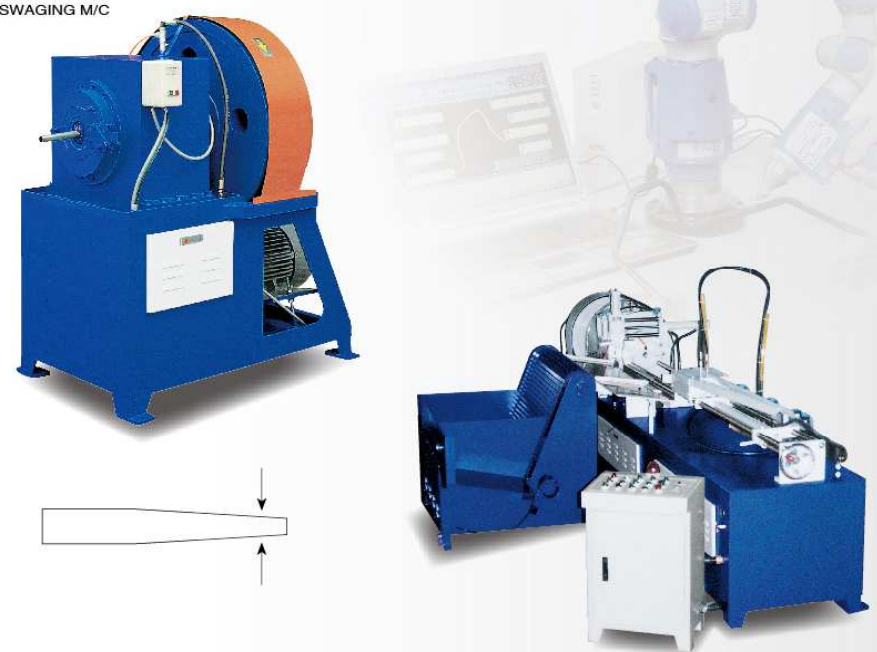

**AUTO CELL**

<http://www.shuztung.com>

**Handing Intelligent Robot**



**Welding Intelligent Robot**



機型/MODEL	2 PCS MOLD TYPE		4 PCS MOLD TYPE		MAX. PIPE LENGTH (mm)	MAX. SWAGING LENGTH(mm)	HP(kw)	DIMENSIONS (cm)	WEIGHT (kw)	
	SUITABLE O.D. (mm)	CYCLE TIME	SUITABLE O.D. (mm)	CYCLE TIME						
AUTO	330A	15.88-32x1.2T	8 sec/ pc	X	X	760	300	10.13	356x112x165	2424
	400A	15.88-32x1.4T	16 sec/ pc	25-50x1.2T	12 sec/ pc	800	360	10.13	366x121x159	3840
	600A	15.88-32x1.4T	24 sec/ pc	25-50x1.2T	20 sec/ pc	850	560	10.13	426x121x159	4200
	400LA	25-50x1.4T	18 sec/ pc	40-85x1.6T	14 sec/ pc	850	360	13.88	415x143x163	4200
	600LA	25-50x1.4T	20 sec/ pc	40-85x1.6T	16 sec/ pc	850	560	17.6	470x143x163	4800
SEMI-AUTO	330S	15.88-32x1.2T	8 sec/ pc	X	X	760	300	10.13	356x90x165	2424
	400S	15.88-32x1.4T	16 sec/ pc	25-50x1.2T	12 sec/ pc	800	360	10.13	366x90x159	3840
	600S	15.88-32x1.4T	24 sec/ pc	25-50x1.2T	20 sec/ pc	850	560	10.13	426x90x159	4200
	400LS	25-50x1.4T	18 sec/ pc	40-85x1.6T	14 sec/ pc	850	360	13.88	415x90x163	4200
	600LS	25-50x1.4T	20 sec/ pc	40-85x1.6T	16 sec/ pc	850	560	17.6	456x90x163	4800
MANUAL(*)	330M	32x1.2T	8 sec/ pc	X	X	X	300	7.7	132x83x143	1730
	400M	32x1.4T	10 sec/ pc	50x1.2T	13 sec/ pc	X	360	7.7	135x90x145	2200

備註REMARK: 小徑以不能成為實心為主要限制 Swaging job not able to execute up to close end (as solid end).